

# Bell Harbor

BELL HARBOR INTERNATIONAL CONFERENCE CENTER

Seattle's Premier  
Waterfront Venue

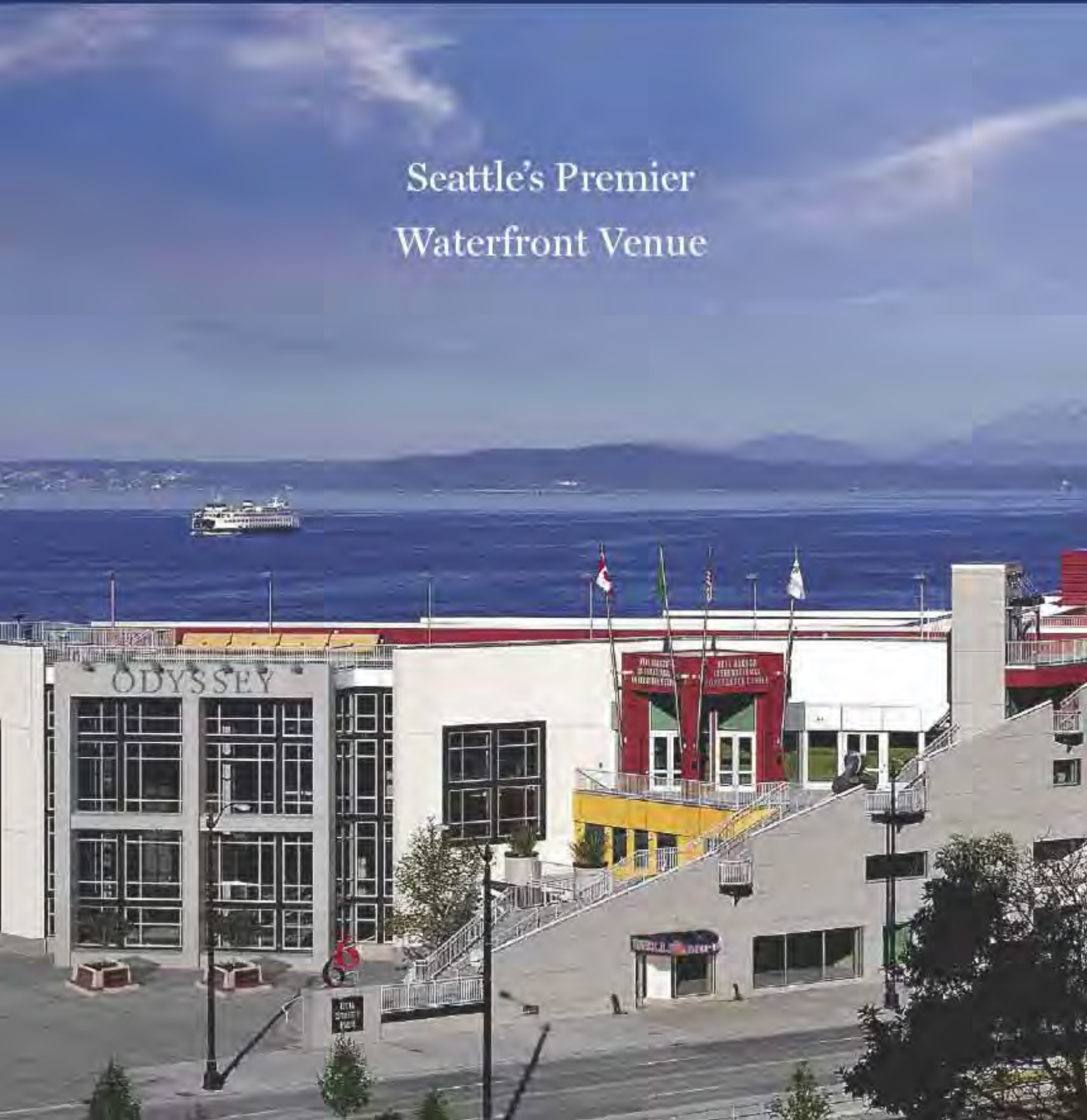

## SEATTLE'S PREMIER WATERFRONT VENUE

"Elliott Bay, the Olympics, ferry boats, breathtaking sunsets—Bell Harbor presents a panorama of maritime magic from its prime location on Seattle's downtown waterfront ... From small meetings to trade shows, whether it's a buffet brunch or evening cocktail party, a business luncheon or formal banquet dinner, Bell Harbor's exceptional staff leaves no detail unattended."

*—Northwest Meetings & Events magazine*

Your event's success is our primary goal at Bell Harbor International Conference Center.

We offer 100,000 square feet of waterfront conference, meeting, and special event space. From the 300-seat Bay Auditorium fashioned after the United Nations, to the Rooftop Plaza with incredible views of Seattle, the Olympics and Mt. Rainier, Bell Harbor sets the stage for history-making occasions for groups from 10 to 5,000.

Located at Bell Street Pier, the neighboring Edgewater and Waterfront Marriott hotels and Anthony's Pier 66 restaurant provide the services you need to make your lodging, and dining experiences memorable.



As one of the Port of Seattle owned waterfront properties, Bell Harbor also manages catering and events for World Trade Center Seattle, Odyssey Maritime Discovery Center, and Pier 30 Event Center.



### WHAT OUR CLIENTS SAY

"The Bell Harbor staff surpassed my expectations...Our attendees commented on how nice the room was, how they enjoyed the fantastic food, and most importantly, how much fun they had at the party ...Thanks again for making our event a hit!"

*Jenna Higgins, Events Manager, Puget Sound Business Journal*

"We would like to extend our thanks for the excellent job you did in supporting our recent Starbucks Global Conference ... We will not hesitate to return to Bell Harbor for future Starbucks events."

*Joyce Hammormasser, Executive Assistant, Starbucks Coffee Company*

"Thank you for making our Annual Meeting held at Bell Harbor a success. We have heard good comments from the meeting attendees, and your attention to detail and flexibility made things run smoothly."

*Koty Diemert, Executive Administrator,  
American College of Physicians - Washington Chapter*



### **The Perfect Meeting**

**A**t Bell Harbor, it's more than just a meeting. This will be the event that your attendees rave about and remember. Our team has all the details mastered. The logistics. The cuisine. The service. The technology. You can concentrate on your meeting's success while our expert team ensures perfect execution.

### **The Complete Meeting Package (CMP)**

It covers everything. Our inclusive CMP ensures that there are no surprises and no unexpected costs. We give you an easy-to-understand, up-front estimate based on a per-person, per-day price. Your CMP will include:

- Main conference room and meeting set-up
- A dedicated, onsite meeting planner
- Continental breakfast
- Mid-morning and afternoon refreshment and snack breaks
- Executive lunch buffet
- Built-in audiovisual equipment, including computer projection systems and screens





### Seattle's Premier Waterfront Meeting Location

You want your team to be meeting-focused. Bell Harbor offers the ideal environment for concentration. Your goals are set. Your objectives are accomplished. Your meeting is a success.

- Over 57,000 square feet of conference center space, outfitted with high ceilings, ample natural light, gathering spaces, and outdoor terraces
- 300-seat auditorium with six private, simultaneous interpretation booths, modeled after the United Nations
- Meeting rooms that feature soundproof walls and adjustable, task-appropriate lighting
- Ergonomically designed Herman Miller chairs for all-day comfort
- Spacious lobby areas complete with data ports in comfortable work space
- Four blocks from Pike Place Market and downtown Seattle
- Adjacent to the Edgewater and Seattle Waterfront Marriott hotels

### Full-Service, Onsite Technology Team

Technology is a critical component for today's successful meeting. And we're experts. In addition to our onsite technology professionals, we offer you the following features:

- Built-in, accessible audiovisual equipment, including capability for ISDN, satellite teleconferencing, and high-speed Internet
- Rear-projection video systems
- Business center with full-time concierge support for general administrative needs

## BELL HARBOR

INTERNATIONAL  
CONFERENCE CENTER

Pier 66, 2211 Alaskan Way  
Seattle, WA 98121-1604  
t 206.441.6666 888.772.4422  
f 206.441.6665  
info@bellharbor.com www.bellharbor.com





**W**orld Trade Center Seattle (WTCSE) is located on the Seattle waterfront, across the street from Bell Harbor International Conference Center. A member of the World Trade Centers Association's network of over 270 facilities around the globe, the WTCSE supports nonprofit tenants through corporate and executive sponsorships. Available for your private social events and business meetings, the venue offers a sophisticated dining room with an upscale bar, an outdoor terrace, and four conference rooms.

The Holland America Line Dining Room is architecturally stunning, with dramatic floor-to-ceiling windows that offer you and your guests panoramic views of Elliott Bay and the Olympic Mountains. Whether you are planning a meeting, reception, intimate wedding, or other gathering, our team will provide you with world-class service in world-class style.

World Trade Center Seattle features:

- Unparalleled, panoramic views of Elliott Bay and the Olympic Mountains from the Holland America Line Dining Room
- Four executive boardrooms with high-speed Internet and built-in, drop-down projector screens
- World-class cuisine and specialty menu offerings for breakfast, lunch, dinner, and receptions
- Onsite concierge, guest services, and dedicated event planner



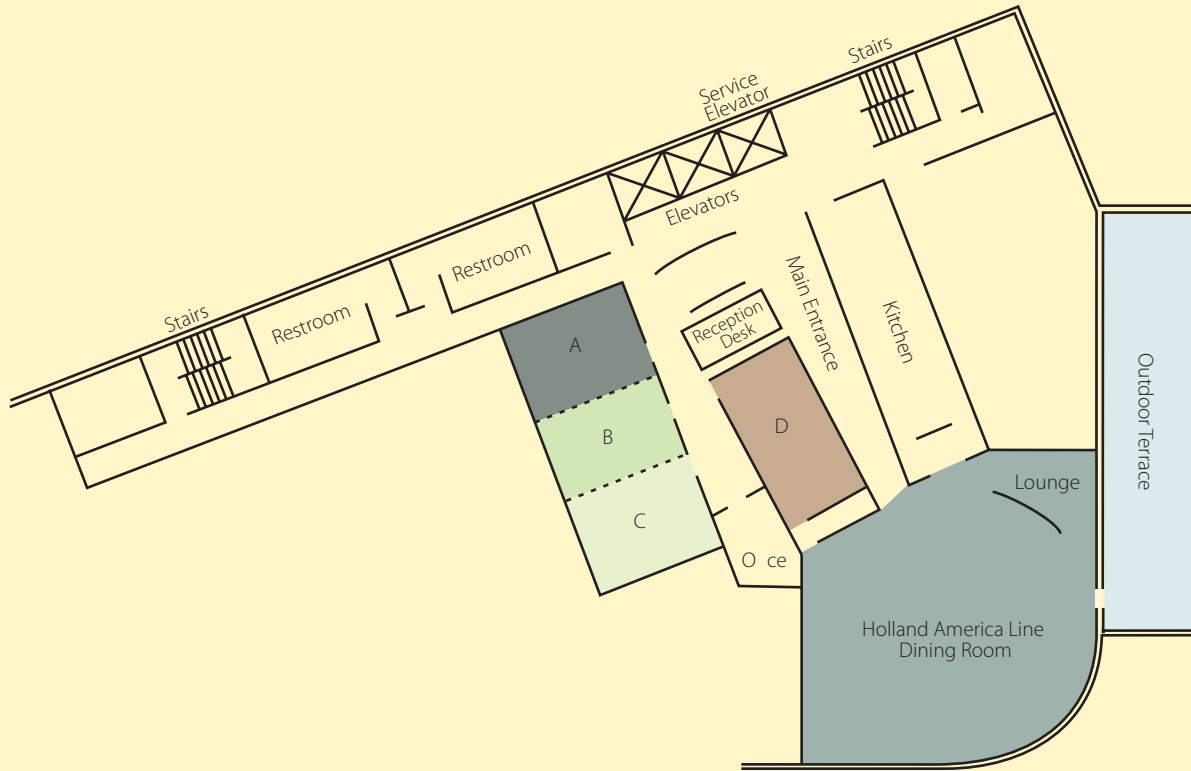

### CAPACITY CHART

Room	Sq. Ft.	Rounds	Conference	Reception
Dining Room	1,800	90	-	130
Executive Boardrooms				
Room A	250	-	10	10
Room B	250	-	10	10
Room C	250	-	10	10
Rooms A + B + C	750	-	26	40
Rooms A + B	500	-	18	25
Rooms B + C	500	-	18	25
Room D	350	-	16	20
Outdoor Terrace	-	-	-	50
All WTCSE	2,900	-	-	170



2200 Alaskan Way, #410  
Seattle, WA 98121-1604

sales t 206.441.6666 f 206.441.6665 info@bellharbor.com www.bellharbor.com

WTCSE info@wtcseattle.com www.wtcseattle.com





The Maritime Event Center (MEC), located adjacent to Bell Harbor International Conference Center, offers an interactive venue on Seattle's thriving waterfront. The nautical-themed galleries at the MEC provide the perfect backdrop for corporate icebreakers, receptions, weddings, proms, bar and bat mitzvahs, and parties for up to 700 guests.

The unique multi-level floor plan of the MEC provides 40-foot-high ceilings, second-level catwalks, intimate gathering spaces, breakout meeting rooms, and spacious galleries, all part of this contemporary maritime event space.

The Maritime Event Center features:

- Interactive maritime exhibits
- Views of Elliott Bay and Seattle's skyline
- 20,665 square feet of event space
- Exclusive catering service provided by Bell Harbor



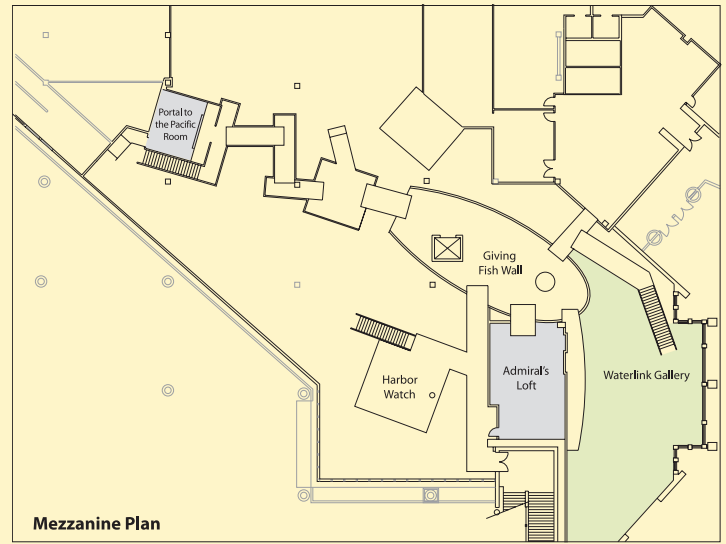
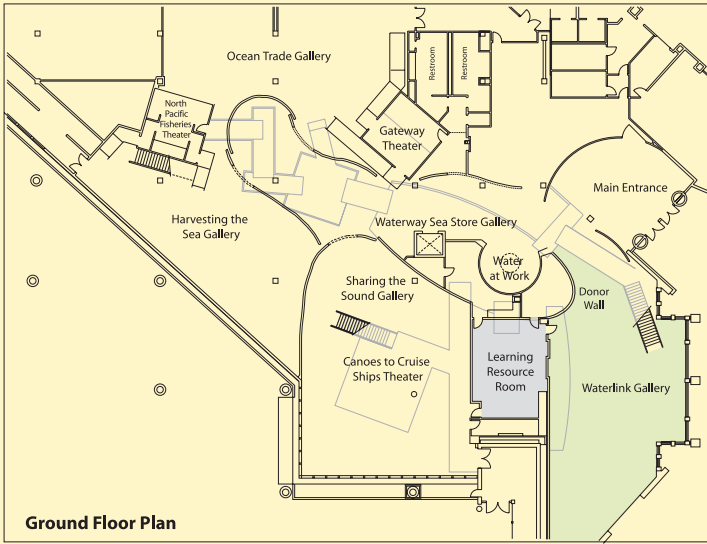

### CAPACITY CHART

Room	Sq. Ft.	Dimensions	Classroom	U-Shape	Conference	Rounds	Reception
Admiral's Loft	888	24' x 37'	35	25	28	60	80
Learning Resource Room	651	21' x 31'	25	18	21	40	60
Portal to the Pacific Room	400	20' x 20'	15	10	12	30	40
Waterlink Gallery	3,000	-	-	-	-	200	275
All Maritime Event Center	20,665	variable	-	-	-	-	700



Pier 66, 2205 Alaskan Way  
Seattle, WA 98121-1604

sales t 206.441.6666 f 206.441.6665 info@bellharbor.com www.bellharbor.com

**Maritime Event Center** www.MaritimeEventCenter.com

Catering and Events Managed by Bell Harbor International Conference Center





### **The Perfect Event in an Extraordinary Location**

**O**ur unmatched, 180-degree panoramic views include the Olympic Mountains, Mt. Rainier, Puget Sound's Elliott Bay, and the Seattle skyline. Bell Harbor offers your guests a stunning location, outstanding service, and amazing cuisine.

Bell Harbor provides an exceptional environment for imagination and celebration. We are the ideal place for your next special event.

- Situated on Seattle's waterfront at Pier 66
- Adjacent to the Edgewater and Seattle Waterfront Marriott hotels
- World-class, award-winning culinary team
- Event space that includes the elegant Harbor Dining Room, the spacious International Promenade, and Elliott Hall
- Spacious lobby areas and access to outdoor, waterfront decks
- Outside spaces that include the Rooftop Plaza, Outdoor Terrace, and Pier Apron
- Ample covered parking garage with convenient pedestrian skybridge access





We'll bring the same passion and expertise to your special event that have attracted world-renowned business leaders to Bell Harbor year after year. We make it our business to ensure everything surrounding your event is flawless. The venue. The cuisine. The service. The fun. While our experts are busy doing what they do best, you can concentrate on what matters most, enjoying your event's success.

### **Exceptional Cuisine**

From a dining and break schedule of your preference, to the intricate detail of a specially prepared menu, Bell Harbor offers:

- Fresh and innovative Northwest-inspired menus
- World-class, award-winning culinary team
- Extraordinary, personalized service



## BELL HARBOR

INTERNATIONAL  
CONFERENCE CENTER

Pier 66, 2211 Alaskan Way  
Seattle, WA 98121-1604  
t 206.441.6666 888.772.4422  
f 206.441.6665  
info@bellharbor.com www.bellharbor.com

